

SHOWER SYSTEM



INNOVATIVE SOLUTIONS FOR CERAMIC AND STONE TILE

INTEGRATED BONDED WATERPROOFING SYSTEM FOR TILED SHOWERS

The Schluter®-Shower System is an integrated family of products that together form a fully bonded, watertight assembly for tiled showers. Unlike shower pan liners in conventional assemblies, bonded waterproof membranes, such as Schluter®-KERDI, bond directly to the mortar bed and protect it from becoming saturated with regular use. In addition, the KERDI membrane or Schluter®-KERDI-BOARD waterproof building panel protect wall cavities from vapor penetration. The Schluter®-KERDI-DRAIN and Schluter®-KERDI-LINE floor drains provide a simple and secure connection to the KERDI membrane at the top of the assembly. Other components include the Schluter®-KERDI-SEAL-PS/-MV prefabricated seals and the Schluter®-KERDI-FIX adhesive/sealant, used to treat protrusions through the membrane, and the Schluter®-KERDI-SHOWER prefabricated substrates, which can reduce weight and installation time. The integrated Schluter®-Shower System eliminates the potential for leakage, efflorescence, and mold growth in the system, is maintenance-free, and dramatically reduces total installation time to ensure success and make shower installation easier than ever.

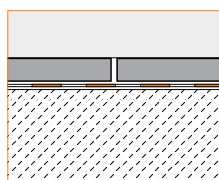

8.1 Schluter®-KERDI

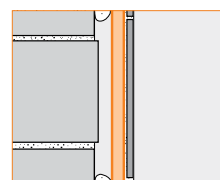

12.1 Schluter®-KERDI-BOARD

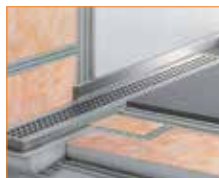

8.2 Schluter®-KERDI-DRAIN
8.7 Schluter®-KERDI-LINE

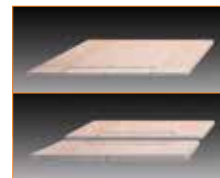

8.3 Schluter®-KERDI-SHOWER-ST
8.8 Schluter®-KERDI-SHOWER-L/-LS

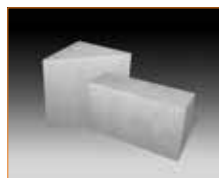

8.3 Schluter®-KERDI-SHOWER
-SC/-SR/-SB



12.1 Schluter®-KERDI-BOARD-SN

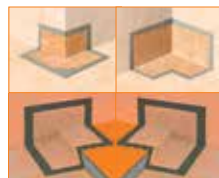

8.1 Schluter®-KERDI-BAND/
-KERECK/-KERS



8.1 Schluter®-KERDI-SEAL-PS/-MV



14.1 Schluter®-SHOWERPROFILE-S/-R



14.1 Schluter®-SHOWERPROFILE
-W/-WSK



Prefabricated Shower Substrates

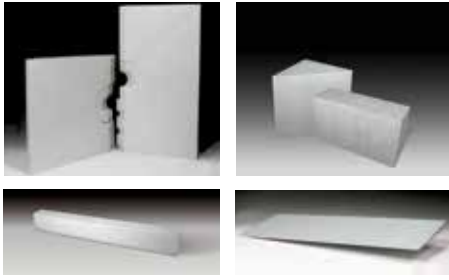

8.3 Schluter®-KERDI-SHOWER-ST/-SC/-SR/-SB

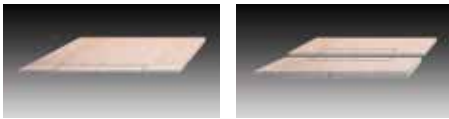

8.8 Schluter®-KERDI-SHOWER-L/-LS



12.1 Schluter®-KERDI-BOARD-SN

Schluter® prefabricated shower substrates provide an alternative to shower bases constructed of mortar and other shower elements constructed of framing and solid backing. The shower tray, curb, ramp, bench, and niche are especially useful in large-scale, repetitive jobs, such as hotels, apartments, and condominiums for the significant time savings that can be realized.

Application and Function

8.3 Schluter®-KERDI-SHOWER-ST/-SC/-SR/-SB are prefabricated substrates, made of expanded polystyrene foam, for use in conjunction with the KERDI waterproofing membrane. The KERDI-SHOWER-ST sloped shower tray is specifically designed to accept the KERDI-DRAIN and is available in 48" x 48" (122 x 122 cm), 32" x 60" (81 x 152 cm), and 72" x 72" (183 x 183 cm) sizes. KERDI-SHOWER-SC is a prefabricated curb that can be used in conjunction with any shower base. Curb dimensions are 48" x 6" x 4-1/2" (122 x 15 x 11.5 cm). KERDI-SHOWER-SR is a ramp designed to facilitate the construction of access ramps for tiled showers. Ramp dimensions are 48" x 15-7/8" x 1-1/2" (122 x 40 x 3.8 cm). The KERDI-SHOWER-SB shower bench is available in triangular and rectangular

8.3 Schluter®-KERDI-SHOWER-ST/-SC/-SR/-SB

| Property | Method | Value |
|-----------------------------------|--------------------|---|
| Density | ASTM D3575 | 2.75 lb/ft ³ (44 Kg/m ³) |
| Compressive Strength ¹ | ASTM D3575 & D1621 | 48 psi (331 kPa) |
| Linear Expansion | ASTM D696 | 3.5 x 10 ⁻⁵ /°F |
| Maximum Service Temperature | - | 175 °F (79 °C) |

¹ Compressive strength measured at 10% deflection of foam

configurations in the following sizes (width x depth x height). The triangular bench is 16" x 16" x 20" (41 x 41 x 51 cm). The rectangular benches are 32" x 11-1/2" x 20" (81 x 29 x 51 cm), 42" x 11-1/2" x 20" (107 x 29 x 51 cm), 48" x 11-1/2" x 20" (122 x 29 x 51 cm), 32" x 16" x 20" (81 x 41 x 51 cm) and 48" x 16" x 20" (122 x 41 x 51 cm).

8.8 Schluter®-KERDI-SHOWER-L/-LS

are prefabricated expanded polystyrene sloped trays with integrated KERDI waterproofing specifically designed to accept the KERDI-LINE linear drain. The trays are available for wall (-LS) or center (-L) drain placement and are available in 39" x 39" (100 x 100 cm) and 55" x 55" (140 x 140 cm) sizes.

12.1 Schluter®-KERDI-BOARD-SN

is a prefabricated shower niche made of KERDI-BOARD that can be installed in both KERDI and KERDI-BOARD wall assemblies. The shower niche features a 1/2" (12.5 mm) -thick by 2" (50 mm) -wide integrated bonding flange and is available in 12" x 6" (30 x 15 cm), 12" x 12" (30 x 30 cm), 12" x 20" (30 x 51 cm), and 12" x 28" (30 x 71 cm) sizes.

Material Properties and Areas of Application

SHOWER-ST/-SC/-SR/-SB/-L/-LS prefabricated substrates are manufactured using lightweight expanded polystyrene. The products require no special disposal and can be recycled. No CFCs or HCFCs are present in either the products or in the manufacturing process. The polystyrene foam has a density of 2.75 lb/ft³ (44 kg/m³) with a 48 psi (331 kPa) compressive strength at 10% deformation. It is serviceable in temperatures up to 175°F (79 °C). The expanded polystyrene used to manufacture KERDI-SHOWER-ST/-SC/-SR/-SB is treated with a flame retarding agent. Expanded polystyrene should not be exposed to hydrocarbons, esters, amines, and aldehydes. All will deteriorate foam.

Exposure to ultraviolet rays (sunlight) for long periods of time will result in partial degradation (dusting) at the surface.

Waterproofing Membrane

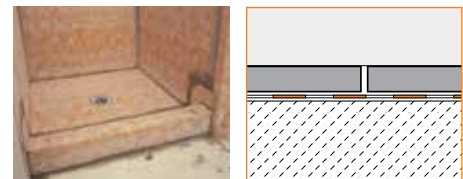

8.1 Schluter®-KERDI

Since traditional shower pan liners are placed below the mortar setting bed in conventional assemblies, moisture is allowed to saturate the mortar bed. This can increase the risk of leakage, cause efflorescence, and foster mold growth. Bonded waterproof membranes, such as KERDI, are set on top of the mortar bed and protect it from becoming saturated, thus eliminating the problems associated with traditional systems.

Application and Function

8.1 Schluter®-KERDI is a pliable, sheet-applied, bonded waterproof membrane and vapor retarder with limited crack-bridging capabilities. It is made of soft polyethylene, which is covered on both sides with a special fleece webbing to anchor the membrane in the thin-set mortar. Tiles can be installed directly on the KERDI membrane using the thin-bed method. Other trowel-applied covering materials, such as plaster, can also be used. **Schluter®-KERDI-DS** is a bonded waterproof membrane and vapor retarder with very low water vapor permeance for use in continuous use steam rooms and similar applications.

Various KERDI waterproofing accessories are available. KERDI-KERECK-F are preformed inside and outside corners. KERDI-KERS-B are preformed, seamless corners for waterproofing 135° angles between triangular shower benches and walls or tops of curbs in neo-angle shower applications.



KERDI-KERS are preformed, seamless corners made of KERDI for waterproofing floor/wall/shower base connections in curbless shower applications where the KERDI-LINE linear drain is installed adjacent to the wall. KERDI-SEAL-PS/-MV are prefabricated sections of KERDI with overmolded rubber gaskets that are used to seal pipe protrusions through the KERDI waterproofing membrane (e.g., at showerheads and tub spouts) and protect moisture-sensitive backing panels at the mixing valve. Use KERDI-BAND, in widths of 5" (12.5 cm), 7-1/4" (18.5 cm), or 10" (25 cm), to seal butt joints or corner joints. KERDI-FLEX, in 5" (12.5 cm) or 10" (25 cm) widths, is used to seal expansion joints or flexible edge joints.

Material Properties and Areas of Application

KERDI bonded waterproof membrane features a polyethylene core with a polypropylene fleece laminated to both sides. The material is physiologically safe and does not require special disposal. KERDI is 8-mil thick and has a water vapor permeance of 0.90 perms, when tested according to ASTM E96, using Procedure E at 90% relative humidity. KERDI-DS is 20-mil thick and features additives to produce a water vapor permeance of 0.18 perms.

KERDI is waterproof and resistant to most chemicals commonly encountered in tiled environments. It is resistant to aging and will not rot. KERDI is highly resistant to saline solutions, acid and alkaline solutions, many organic solvents, alcohols, and oils. Information regarding its resistance to specific substances can be provided if concentration, temperature, and duration of exposure are known. For acid-resistant coverings, use an epoxy adhesive to set and grout the tile.

KERDI is suitable for wall and floor surfaces where protection against the penetration of moisture or other harmful substances is necessary. Applications include showers, intermittent use steam showers, tub surrounds, and areas surrounding swimming pools. Industrial applications include the food industry, breweries, and dairies. KERDI-DS is suitable for use in continuous use steam rooms and other applications with similar vapor management requirements.

KERDI meets the American National Standard for Load Bearing, Bonded, Waterproof Membranes for Thin-Set Ceramic Tile and Dimension Stone Installations (ANSI A118.10). The membrane is listed by cUPC® and evaluated by ICC-ES (Report No. ESR-2467). For copies of these documents, please contact Schluter®-Systems at 800-472-4588 (USA) or 800-667-8746 (Canada) or by e-mail at info@schluter.com. Links to the documents can also be accessed at www.schluter.com.

KERDI has been independently tested and found to emit zero VOCs per California Specification 01350: "Standard Practice for the Testing of Volatile Organic Emissions from Various Sources Using Small-Scale Environmental Chambers". Thus, KERDI can contribute towards achieving the following green building credits:

- LEED, IEQ Credit 4.3: Low-Emitting Materials - Flooring Systems
- ICC 700-2008, 901.6: Pollutant Source Control - Hard-Surface Flooring
- CHPS, EQ2.2: Low-Emitting Materials

Waterproof Building Panel



12.1 Schluter®-KERDI-BOARD

The KERDI-BOARD waterproof building panel simplifies shower installation by combining the tile backing and waterproofing installation into a single step. KERDI-BOARD gives tile setters more control over their projects by providing them with the means to simply and easily create ideal substrates for tile. Unsuitable substrates can be remedied and new substrates can be created while keeping the requirements of the tile covering in mind.

Application and Function

12.1 Schluter®-KERDI-BOARD is a multifunctional tile substrate and building panel, which can also be used for creating bonded waterproofing assemblies with tile coverings. It consists of an extruded polystyrene foam panel, with a special reinforcement material on both sides and fleece webbing for effective anchoring in thin-set mortar.

With the available panel thicknesses of 3/16", 3/8", 1/2", 5/8", 3/4", 1", 1-1/2", and 2" (5, 9, 12.5, 15, 19, 25, 38, and 50 mm), KERDI-BOARD covers a broad range of application areas for creating flat, level, plumb, square, and dimensionally stable substrates for the installation of ceramic and natural stone tiles. With suitable preparation of the abutting seams and joint areas, the panel may be used for bonded waterproofing assemblies.

KERDI-BOARD is suitable for: creating tile substrates on masonry walls, wood or metal framing, and other finished wall surfaces; creating straight or curved partition walls; creating straight or curved bathtub and shower surrounds; concealing pipes and columns; as well as creating bathtub platforms, vanities, storage shelves, countertops, and various other bathroom structures.

The boards are simply cut to size with a utility knife. The gridlines, which are printed on the surface, are helpful for neat and quick cuts and installation. KERDI-BOARD can be fully adhered in wall areas or spot-bonded with thin-set mortar. If necessary, the material may be secured with additional wall anchors. In the case of stud framing, KERDI-BOARD is attached with screws and washers from the matching hardware system. Tiles can be installed directly over KERDI-BOARD using the thin-set method.

L-shaped and U-shaped KERDI-BOARD panels are available for creating pipe and column coverings, and grooved panels are available for creating curved elements. Schluter®-Systems also offers profiles and attachment hardware for wall connections and finishing edges, as well as matching wall anchors and screws.

Material Properties and Areas of Application

KERDI-BOARD is made from extruded polystyrene foam, with a cement-free reinforcement layer laminated to both sides and an anchoring fleece webbing. The surface of the board has gridlines consisting of 3/8" x 3/8" (10 x 10 mm) squares printed on one side.

KERDI-BOARD is waterproof and vapor retardant and can withstand all chemical stresses that typically occur in conjunction



with ceramic tile coverings. KERDI-BOARD may be used in bonded waterproofing assemblies where required. KERDI-BOARD is completely flat and will not warp, even with one-sided exposure to temperature and moisture fluctuations. It will not rot or decay. KERDI-BOARD can be used in a multitude of different application areas. In special cases, the suitability of the material must be verified based on the anticipated chemical and mechanical stresses. The information provided below is intended as general guidelines.

Structures on which KERDI-BOARD is to be installed must be stable and meet any other project-specific requirements. Select a suitable material thickness if using KERDI-BOARD for the construction of freestanding partition walls, shelving, or similar structures, and use reinforcement profiles as necessary. Arrange supports made of KERDI-BOARD at regular intervals consistent with conventional building practices. Select the material thickness and installation method depending on the evenness of the substrate. KERDI-BOARD can be spot-bonded to walls to correct substrate variations or fully embedded in thin-set mortar where walls are sufficiently even and plumb.

Maintenance

Storage

KERDI-BOARD should be stored flat. In case of outdoor storage, protect the material from direct sunlight and weather exposure.

Shower Drains

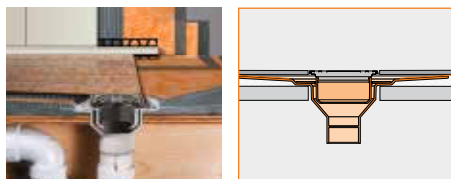

8.2 Schluter®-KERDI-DRAIN

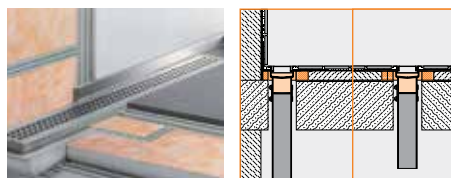

8.7 Schluter®-KERDI-LINE

12.1 Schluter®-KERDI-BOARD

| Property | Method | Value |
|------------------------------|-----------------------|--|
| Water vapor permeance | ASTM E96 ¹ | 0.36 perms - 1/2" (12.5 mm) |
| Thermal resistance (R-value) | ASTM C518 | R 9.1 - 2" (50 mm) R 2.2 - 1/2" (12.5 mm) R 0.9 - 3/16" (5 mm) |
| Service temperature range | | -58°F to 158°F (-50°C to 70°C) |
| Flame spread/smoke developed | ASTM E84 | Pass ² |
| Thermal barrier evaluation | NFPA 286 | Pass ^{2,3} |

¹ Using the desiccant method at 100°F (38°C) and 90% RH

² Per International Building Code Requirements

³ Porcelain tile used as thermal barrier over 1/2" (12.5 mm) -thick KERDI-BOARD on wood framing

Conventional two-stage drains are designed to connect to shower pan liners below the mortar bed and do not allow a secure, watertight connection to bonded waterproof membranes at the top of the drain assembly. KERDI-DRAIN and KERDI-LINE are designed specifically to ensure a simple and secure connection to bonded waterproof membranes, such as KERDI, at the top of the assembly rather than below it, thereby reducing the risk of leakage, efflorescence, and mold growth.

Application and Function

8.2 Schluter®-KERDI-DRAIN is a floor drain specifically designed to allow connections to KERDI or other load-bearing, bonded waterproof membranes. The membrane is adhered to the large integrated bonding flange to form a waterproof connection at the top of the drain assembly. KERDI-DRAIN consists of a drain casing and fully adjustable grate assembly or covering support to which tile is applied. The grate assembly accommodates a wide range of tile thicknesses and allows lateral and tilt adjustment as well. The covering support is placed flush with the top of the bonding flange and can therefore accommodate any thickness tile covering. The standard KERDI-DRAIN is attached directly to the waste line. The drain casing is available in ABS, PVC, or stainless steel. The plastic drain casings feature a fleece-covered bonding flange. They are available with standard 2" (50 mm) and 3" (75 mm) outlets and attached to the pipe using an appropriate solvent cement. The stainless steel drain casings are available with standard 2" (50 mm) or 3" (75 mm) no-hub outlets or 2" (50 mm) threaded outlet. The no-hub outlets are attached to the pipe using an appropriate mechanical (e.g., flexible or no-hub) coupling. The threaded outlets are attached to the pipe using thread sealing compound or tape. The simple connection to standard drain

outlets makes KERDI-DRAIN suitable for new construction and renovation.

The KERDI-DRAIN adaptor kit is designed to convert clamping ring drains by equipping them with an integrated bonding flange. The adaptor kit includes a stainless steel adaptor ring with an over-molded rubber gasket and a variety of perforated hole patterns that align with most common clamping ring shower drains. The adaptor ring replaces the clamping ring and is attached to the drain body using the clamping ring bolts. This connection is made watertight via the rubber gasket and KERDI-FIX adhesive/sealant. The integrated bonding flange slides into the adaptor ring, with the over-molded rubber gasket ensuring a watertight seal. Commercial KERDI-DRAIN adaptor kits feature a 7-1/2" (191 mm) diameter adaptor ring and are available with a stainless steel bonding flange or an ABS bonding flange. The ABS bonding flange is available in two sizes (standard or extended length) to accommodate different tile assembly thicknesses. The residential KERDI-DRAIN adaptor kit features a 5-1/4" (133 mm) diameter adaptor ring and an ABS bonding flange. The KERDI-DRAIN adaptor kit is particularly useful in renovations where the clamping ring drains are difficult to replace with the standard KERDI-DRAIN (e.g., when they are set in concrete slabs). The grate assembly consists of a height adjustment collar, lateral adjustment ring, and drain grate or covering support. The grates are installed in conjunction with a height adjustment collar and lateral adjustment ring, which are made of ABS or stainless steel, to allow for simple and convenient adjustment when setting the tile. Drain grates are available in stainless steel with a polished or oil-rubbed bronze finish and in anodized aluminum with a brushed copper bronze, brushed brass, or brushed nickel finish. The polished stainless steel grates are available in 4" (100 mm) -square, 6" (150 mm) -square and -round versions. All other grates are available in the



4" (100 mm) -square version only. Please note that grate assemblies included with the plastic KERDI-DRAIN featuring 3" (75 mm) outlets and the residential adaptor kits only allow vertical and tilt adjustment (no lateral adjustment). The covering support is a 4" (100 mm) -square stainless steel plate with KERDI laminated on the surface to allow for bonding of ceramic or stone tile, which creates a virtually invisible drainage line.

8.7 Schluter®-KERDI-LINE is a low profile linear floor drain specifically designed for bonded waterproofing assemblies. KERDI-LINE can be installed adjacent to walls or at intermediate locations. The floor can be sloped on a single plane to KERDI-LINE, which enables the use of large-format tiles and creates interesting design opportunities.

KERDI-LINE consists of a formed stainless steel channel body and grate assembly or covering support to which tile is applied. The channel body features a standard 2" (50 mm) no-hub outlet and is attached to the pipe using an appropriate mechanical (e.g., flexible or no-hub) coupling. The simple connection to standard drain outlets makes KERDI-LINE suitable for new construction and renovation. KERDI-LINE is available with both center and off-set outlets. The off-set outlet is located 8" (20.3 cm) from the edge of the channel body and provides flexibility when obstacles (e.g., floor joists) are encountered during installation. The grate assembly can be seamlessly adjusted to the thickness of the ceramic tile or stone covering from 1/8" to 1" (3 mm to 25 mm). The covering support is placed flush with the top of the channel body and can therefore accommodate any thickness tile covering.

KERDI-LINE includes a corresponding polystyrene foam channel support. The perimeter of the channel body consists of a bonding flange laminated with a collar made of KERDI. It ensures a simple and secure connection to the bonded waterproofing assembly, both in the floor area and on adjacent walls.

The grate assembly consists of a brushed stainless steel frame and two design grate options. Option A is a closed-design, brushed stainless steel grate. Option B is a brushed stainless grate with square perforations. Option B is also available with a locking mechanism (3/4" - 19 mm frame only) for applications where tamper resistance is desired or required (e.g., healthcare and education facilities, etc.).

The covering support D is a stainless steel plate with KERDI waterproofing membrane laminated on the surface to allow for bonding of ceramic or stone tile, which creates a virtually invisible drainage line. KERDI-LINE is available in channel lengths from 20" to 72" (50 cm to 180 cm) in 4" (10 cm) increments. Please note that the bonding flange extends approximately 1" (2.5 cm) beyond the channel on all sides.

Schluter®-KERDI-LINE-FC is a stainless steel cover plate for use with KERDI-LINE to create a seamless look in applications where multiple drains are installed end-to-end. KERDI-LINE-FC features a brushed finish, and is designed for use with either the solid or perforated grates with brushed stainless steel frame.

14.1 Schluter®-SHOWERPROFILE-S/-R system profiles represent an elegant solution for finishing the area between the floor and the first course of wall tile in a way that eliminates cutting wedges of tile and ensures a consistent elevation of the first course of wall tile in KERDI-LINE applications. SHOWERPROFILE-S consists of a trapezoid-perforated anchoring leg with a groove, which accepts a tapered brushed stainless steel profile that matches the slope of the KERDI-SHOWER-L shower tray. The profile is adjusted to cover the exposed wall area and forms the visible surface. SHOWERPROFILE-R consists of a brushed stainless steel profile and corresponding channel. The profile is adjusted to fit the space between the KERDI-LINE and the wall tile and forms the visible surface in applications where the KERDI-LINE is placed adjacent to a wall.

Material Properties and Areas of Application

KERDI-DRAIN drain casings are formed using ABS, PVC, or stainless steel 304 (1.4301 = V2A). Plastic drain casings feature a polypropylene fleece webbing. The KERDI-DRAIN adaptor kits feature adaptor rings made of stainless steel 304 (1.4301 = V2A) with thermoplastic rubber gaskets and adaptor flanges made of stainless steel 304 (1.4301 = V2A) or ABS. Drain grates are available in stainless steel 304 (1.4301 = V2A) and anodized aluminum. The covering support is stainless steel 304 (1.4301 = V2A) with KERDI laminated on the surface.

The KERDI-LINE channel body is formed using stainless steel 316 L (1.4404 =V4A) and features a bonding flange with a KERDI

collar laminated on the surface. KERDI is a bonded waterproof membrane made of soft polyethylene, which is covered on both sides with a special fleece webbing to anchor the membrane in the thin-set mortar. The frame and grates are made of stainless steel 316 L (1.4404 =V4A). The channel support is made of pressure-resistant, expanded polystyrene (EPS).

KERDI-DRAIN and KERDI-LINE are suitable for use in residential and commercial applications, including areas subject to foot and wheelchair traffic, such as showers and wet rooms in homes, hotels, schools, healthcare facilities, etc.

Stainless steel can sustain high mechanical stresses and is particularly suitable for applications requiring resistance against chemicals and acids. However, even stainless steel is not resistant to all chemical stresses, and may be affected by hydrochloric acid, hydrofluoric acid or certain chlorine, chloride, and brine concentrations, which may be present in detergents or swimming pools. In special cases, the suitability of the selected floor drainage system must be verified based on the anticipated chemical, mechanical, and/or other stresses.

Anodized aluminum retains a uniform appearance during normal use. The surface, however, is susceptible to scratching and wear and may be damaged by grout or setting material. Therefore, these materials must be removed immediately.

Various configurations of KERDI-DRAIN and KERDI-LINE are listed by UPC®, CSA, ICC-ES PMG and NSF. Relevant industry standard guidelines for floor drains with integrated bonding flange include method B422 in the Tile Council of North America's (TCNA) Handbook for Ceramic Tile Installation and Method 326DR in the Terrazzo, Tile and Marble Association of Canada (TTMAC) Specification Guide 09300 Tile Installation Manual.

The KERDI-LINE-FC is roll-formed using stainless steel 316 L (1.4404 = V4A).

The SHOWERPROFILE-S anchoring leg is made of recycled, rigid PVC. The SHOWERPROFILE-S/-R profiles are made of stainless steel 316 L (1.4404 = V4A) with KERDI laminated on the backside.

Maintenance

KERDI-DRAIN, KERDI-LINE, and SHOWERPROFILE-S/-R require no special maintenance and are resistant to mold and fungi. The drain grates may be removed to clean the drain housing and the drain pipes.



Clean the grates and profiles using common household cleaning agents. Stainless steel exposed to the environment or aggressive substances should be cleaned periodically using a mild household cleaner. Regular cleaning maintains the neat appearance of stainless steel and reduces the risk of corrosion. All cleaning agents must be free of hydrochloric acid, hydrofluoric acid, and chlorides. Stainless steel surfaces develop a sheen when treated with a chrome-polishing agent. Do not use abrasive or alkaline cleaning agents.

Shower Profiles

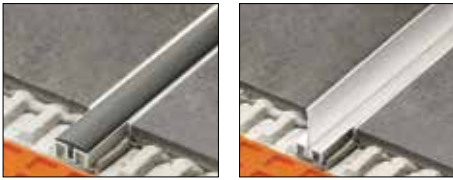

14.2 Schluter®-WS/-WSC/-WSL

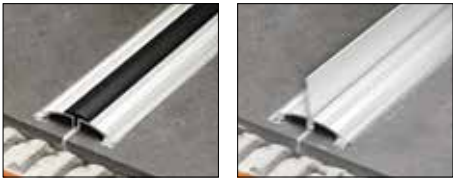

14.2 Schluter®-WSK/-WSC/-WSL

Application and Function

14.2 Schluter®-SHOWERPROFILE-WS/-WSK system profiles, together with the Schluter®-SHOWERPROFILE-WSL/-WSC inserts, form a splashguard at the entrance of curbless showers.

Schluter®-SHOWERPROFILE-WS is an anodized aluminum support profile that is set in conjunction with the tile using thin-set mortar. It has a 3/4" (19 mm) –wide visible surface and a height of 5/16" (8 mm). Where thicker tiles are used, simply fill the space below the profile with thin-set mortar.

Schluter®-SHOWERPROFILE-WSK is an anodized aluminum support profile that is adhered to the tile surface. It has a 2-1/16" (52 mm) –wide visible surface and a height of 5/16" (8 mm).

The support profiles are combined with either the SHOWERPROFILE-WSL insert or the SHOWERPROFILE-WSC insert.

Schluter®-SHOWERPROFILE-WSL is an upright insert made of transparent polyurethane. The insert is collapsible when

stepped on or rolled over with a wheelchair. The insert protrudes 1-5/32" (29 mm) above the profile surface. The SHOWERPROFILE-WSL insert does not comply with the Americans with Disabilities Act (ADA), since it exceeds the allowable height of a vertical transition despite being collapsible. Please check with local code officials for acceptance on projects where ADA guidelines must be observed before installation.

Schluter®-SHOWERPROFILE-WSC is a semi-circular insert made of semi-rigid PVC. The insert creates an inconspicuous transition from the shower area to the adjoining space and a 5/8" (16 mm) –wide visible surface. The insert protrudes 3/64" (1.2 mm) above the profile surface. The SHOWERPROFILE-WSC insert complies with the Americans with Disabilities Act (ADA).

Material Properties and Areas of Application
The SHOWERPROFILE-WS/-WSK support profiles feature an anodized aluminum layer that retains uniform appearance during normal use. The surface, however, is susceptible to scratching and wear and may be damaged by grout or setting material. Cementitious materials, in conjunction with moisture, become alkaline. Since aluminum is sensitive to alkaline substances, exposure to the alkali (depending on the concentration and duration of exposure) may result in corrosion (aluminum hydroxide formation). Therefore, it is important to remove mortar or grout residue immediately from visible surfaces. In addition, ensure the profile is solidly embedded in the setting material and that all cavities are filled to prevent the collection of alkaline water.

The SHOWERPROFILE-WSL insert is made of highly flexible polyurethane.

The SHOWERPROFILE -WSC insert is made of semi-rigid PVC.

The inserts can withstand chemical stresses typically encountered in tiled environments.

Maintenance

SHOWERPROFILE-WS/-WSK support profiles require no special maintenance or care and are resistant to mold and fungi. In the case of anodized aluminum, do not use abrasive cleaning agents. The SHOWERPROFILE-WSC/ -WSL inserts are specifically treated to resist the growth of

fungi and bacteria and require no special maintenance or care.

Adhesive/Sealant



8.3 Schluter®-KERDI-FIX

Any protrusions through the KERDI membrane can be treated with KERDI-FIX, or equivalent sealant, to ensure a fully waterproof assembly.

Application and Function

8.3 Schluter®-KERDI-FIX is a single-component, waterproof sealing and bonding compound with a silane-modified polymer base, which can be used in various applications. In conjunction with KERDI, KERDI-FIX can be used to waterproof pipe and valve protrusions in the Schluter®-Shower System. KERDI-FIX is used to bond the KERDI membrane to the stainless steel KERDI-DRAIN bonding flange. KERDI-FIX can also be used to bond KERDI to building elements such as bathtubs, window elements and door frames.

Material Properties and Areas of Application

KERDI-FIX has been independently tested to determine VOC emissions per California Specification 01350: "Standard Practice for the Testing of Volatile Organic Emissions from Various Sources Using Small-Scale Environmental Chambers", found to emit zero VOCs, and can contribute towards achieving the following green building credits:

- LEED, IEQ Credit 4.3: Low-Emitting Materials - Flooring Systems
- ICC 700-2008, 901.6: Pollutant Source Control - Hard-Surface Flooring
- CHPS, EQ2.2: Low-Emitting Materials



Maintenance

Storage

Unopened packages of KERDI-FIX can be stored in a cool place for up to 18 months. Once the cartridge has been opened, the material has a limited shelf life.

System Installation

For complete installation guidelines and warranty criteria for shower applications, please contact Schluter®-Systems at 800-472-4588 (USA) or 800-667-8746 (Canada) to receive a copy of the Schluter®-Shower System Installation Handbook and a step-by-step installation video. To download a PDF version of the Handbook or to view the installation video online, please visit www.schluter.com.

Schluter®-KERDI-FIX Technical Data

| | |
|--|---|
| Color | Grey or bright white |
| Basic raw material | Silyl-modified polymer (SMP) |
| Specific weight | Approx. 93.6 lb/ft ³ (1.5 g/ml) |
| Solvent content | 0% |
| Isocyanate content | 0% |
| Dry materials content | Approx. 100% |
| VOC emissions | 0.0 mg/m ³ |
| Shear strength beech wood/beech wood | Approx. 435 psi (3 N/mm ²) |
| Shear strength aluminum/aluminum | Approx. 290 psi (2 N/mm ²) |
| Elongation at failure | Approx. 200% |
| Skinning | About 10 minutes |
| Curing | 1/8" (3 mm) per 24 hours |
| Permissible total movement | About 20% |
| Processing temperatures | Don't install at temperatures below 40 °F (5 °C) |
| Temperature stability | -40 °F (-40 °C) to 212 °F (100 °C), temporarily 356 °F (180 °C) [max. 30 minutes] |
| Moisture resistance | Very good |
| Frost ability | Not sensitive to frost |
| Cartridge volume | 9.81 oz (290 ml) |
| Estimated coverage | |
| 5" (12.7 cm) connection to fixed building elements | 12' 10" (3.9 m) per cartridge |
| 1/4" (6 mm) bead | 30' 1" (9.2 m) per cartridge |



Product Item Numbers



| 8.3 Schluter®-KERDI-SHOWER-ST | | Prefabricated EPS shower tray | | |
|-------------------------------|--------------|-------------------------------|------------------|-----------------|
| Item No. | Width | Length | Perimeter Height | Drain Placement |
| ST 122 | 48" - 122 cm | 48" - 122 cm | 1-1/2" - 3.8 cm | Center |
| ST-81/152 | 32" - 81 cm | 60" - 152 cm | 1-3/4" - 4.4 cm | Center |
| ST-81/152 BR | 32" - 81 cm | 60" - 152 cm | 1-1/2" - 3.8 cm | Off-center* |
| ST-183 | 72" - 183 cm | 72" - 183 cm | 1-1/2" - 3.8 cm | Center |

*Off-center drain at 10" (25 cm) from end of tray



| 8.8 Schluter®-KERDI-SHOWER-LS | | Shower tray - wall drain placement | | |
|-------------------------------|--------------|------------------------------------|------------------|--|
| Item No. | Width | Length | End Height | |
| KSL 1000 S | 39" - 100 cm | 39" - 100 cm | 1-21/32" - 42 mm | |
| KSL 1400 S | 55" - 140 cm | 55" - 140 cm | 2" - 50 mm | |



| 8.8 Schluter®-KERDI-SHOWER-L | | Shower tray - center drain placement | | |
|------------------------------|--------------|--------------------------------------|------------------|--|
| Item No. | Width | Length | End Height | |
| KSL 1000 | 39" - 100 cm | 39" - 100 cm | 1-1/4" - 32 mm | |
| KSL 1400 | 55" - 140 cm | 55" - 140 cm | 1-13/32" - 36 mm | |



| 8.3 Schluter®-KERDI-SHOWER-SC | | Prefabricated EPS curb | | |
|-------------------------------|------------------|------------------------|------------|--|
| Item No. | Width | Length | Height | |
| SC 122 | 4-1/2" - 11.5 cm | 48" - 122 cm | 6" - 15 cm | |



| 8.3 Schluter®-KERDI-SHOWER-SR | | Prefabricated EPS ramp | | |
|-------------------------------|--------------|------------------------|-----------------|--|
| Item No. | Width | Length | Height | |
| SR 122 | 48" - 122 cm | 15-7/8" - 40 cm | 1-1/2" - 3.8 cm | |

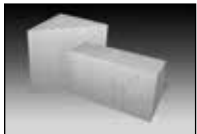

| 8.3 Schluter®-KERDI-SHOWER-SB | | Prefabricated EPS bench | | |
|-------------------------------|--------------|-------------------------|-------------|-------------|
| Item No. | Width | Depth | Height | Shape |
| SB 41 | 16" - 41 cm | 16" - 41 cm | 20" - 51 cm | Triangular |
| SB 2981 | 32" - 81 cm | 11-1/2" - 29 cm | 20" - 51 cm | Rectangular |
| SB 29107 | 42" - 107 cm | 11-1/2" - 29 cm | 20" - 51 cm | Rectangular |
| SB 29122 | 48" - 122 cm | 11-1/2" - 29 cm | 20" - 51 cm | Rectangular |
| SB 4181 | 32" - 81 cm | 16" - 41 cm | 20" - 51 cm | Rectangular |
| SB 41122 | 48" - 122 cm | 16" - 41 cm | 20" - 51 cm | Rectangular |



| 8.1 Schluter®-KERDI | | Waterproofing membrane | | |
|---------------------|-------------|------------------------|---|-----------|
| Item No. | Width | Length | Area | Thickness |
| KERDI 200/5M | 3' 3" - 1 m | 16' 5" - 5 m | 54 ft ² - 5 m ² | 8 mil |
| KERDI 200/10M | 3' 3" - 1 m | 33' - 10 m | 108 ft ² - 10 m ² | 8 mil |
| KERDI 200/20M | 3' 3" - 1 m | 65' 7" - 20 m | 215 ft ² - 20 m ² | 8 mil |
| KERDI 200 | 3' 3" - 1 m | 98' 5" - 30 m | 323 ft ² - 30 m ² | 8 mil |

| 8.1 Schluter®-KERDI-DS | | Waterproofing membrane | | |
|------------------------|-------------|------------------------|---|-----------|
| Item No. | Width | Length | Area | Thickness |
| KERDI-DS | 3' 3" - 1 m | 98' 5" - 30 m | 323 ft ² - 30 m ² | 20 mil |



12.1 Schluter®-KERDI-BOARD Waterproof building panel

| Item No. | Width | Length | Thickness |
|-----------------|-------------------|----------------|----------------|
| KB 12 1220 812 | 48" – 122 cm | 32" – 81 cm | 1/2" – 12.5 mm |
| KB 5 1220 1625 | 48" – 122 cm | 64" – 162.5 cm | 3/16" – 5 mm |
| KB 9 1220 1625 | 48" – 122 cm | 64" – 162.5 cm | 3/8" – 9 mm |
| KB 12 1220 1625 | 48" – 122 cm | 64" – 162.5 cm | 1/2" – 12.5 mm |
| KB 5 1220 2440 | 48" – 122 cm | 96" – 244 cm | 3/16" – 5 mm |
| KB 9 1220 2440 | 48" – 122 cm | 96" – 244 cm | 3/8" – 9 mm |
| KB 12 1220 2440 | 48" – 122 cm | 96" – 244 cm | 1/2" – 12.5 mm |
| KB 15 1220 2440 | 48" – 122 cm | 96" – 244 cm | 5/8" – 15 mm |
| KB 19 625 2440 | 24-1/2" – 62.5 cm | 96" – 244 cm | 3/4" – 19 mm |
| KB 25 625 2440 | 24-1/2" – 62.5 cm | 96" – 244 cm | 1" – 25 mm |
| KB 38 625 2440 | 24-1/2" – 62.5 cm | 96" – 244 cm | 1-1/2" – 38 mm |
| KB 50 625 2440 | 24-1/2" – 62.5 cm | 96" – 244 cm | 2" – 50 mm |
| KB 15 1220 3050 | 48" – 122 cm | 120" – 305 cm | 5/8" – 15 mm |



12.1 Schluter®-KERDI-BOARD-SN Shower niche

| Item No. | Size | Depth | Shelf |
|---------------------|--------------------------|----------------|-------|
| KB 12 SN 305 152 A | 12" x 6" – 305 x 152 mm | 3-1/2" – 89 mm | - |
| KB 12 SN 305 305 A | 12" x 12" – 305 x 305 mm | 3-1/2" – 89 mm | - |
| KB 12 SN 305 508 A1 | 12" x 20" – 305 x 508 mm | 3-1/2" – 89 mm | 1 |
| KB 12 SN 305 711 A1 | 12" x 28" – 305 x 711 mm | 3-1/2" – 89 mm | 1 |



8.1 Schluter®-KERDI-BAND Waterproofing strip

| Item No. | Width | Length | Thickness |
|------------------|------------------|---------------|-----------|
| KEBA 100/125/5M | 5" – 12.5 cm | 16' 5" – 5 m | 4 mil |
| KEBA 100/125/10M | 5" – 12.5 cm | 33' – 10 m | 4 mil |
| KEBA 100/185/5M | 7-1/4" – 18.5 cm | 16' 5" – 5 m | 4 mil |
| KEBA 100/250/5M | 10" – 25 cm | 16' 5" – 5 m | 4 mil |
| KEBA 100/125 | 5" – 12.5 cm | 98' 5" – 30 m | 4 mil |
| KEBA 100/185 | 7-1/4" – 18.5 cm | 98' 5" – 30 m | 4 mil |
| KEBA 100/250 | 10" – 25 cm | 98' 5" – 30 m | 4 mil |



8.1 Schluter®-KERDI-FLEX Waterproofing strip for use above movement joints

| Item No. | Width | Length | Thickness |
|-------------|--------------|---------------|-----------|
| FLEX 125/5M | 5" – 12.5 cm | 16' 5" – 5 m | 12 mil |
| FLEX 250/5M | 10" – 25 cm | 16' 5" – 5 m | 12 mil |
| FLEX 125/30 | 5" – 12.5 cm | 98' 5" – 30 m | 12 mil |
| FLEX 250/30 | 10" – 25 cm | 98' 5" – 30 m | 12 mil |



8.1 Schluter®-KERDI-KERECK-F Preformed corner

| Item No. | Thickness | Packaging |
|----------------|-----------|--------------------|
| KERECK / FI 2 | 4 mil | 2 inside corners |
| KERECK / FI 10 | 4 mil | 10 inside corners |
| KERECK / FA 2 | 4 mil | 2 outside corners |
| KERECK / FA 10 | 4 mil | 10 outside corners |



8.1 Schluter®-KERDI-KERS-B Preformed corner

| Item No. | Thickness | Description | Packaging |
|----------------|-----------|-----------------------------|--|
| KERECK135/FI2 | 4 mil | Inside corner, 135° | 2 units |
| KERECK135/FI10 | 4 mil | Inside corner, 135° | 10 units |
| KERSB135KLR | 4 mil | Bench corners | 1 right and 1 left |
| KERSB135K5LR | 4 mil | Bench corners | 5 right and 5 left |
| KERSB135K | 4 mil | Bench/ neo-angle corner kit | 1 right and 1 left bench corner, and 2 135° inside corners |

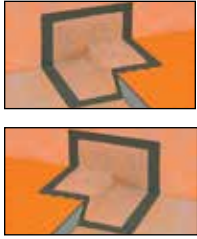
**8.1 Schluter®-KERDI-KERS**

Preformed corner

| Item No. | Thickness | Packaging |
|----------|-----------|-----------------------------|
| KERS 20L | 4 mil | Left inside corner – 20 mm |
| KERS 28L | 4 mil | Left inside corner – 28 mm |
| KERS 20R | 4 mil | Right inside corner – 20 mm |
| KERS 28R | 4 mil | Right inside corner – 28 mm |

**8.1 Schluter®-KERDI-SEAL-PS**

Pipe seal with over-molded rubber gasket

| Item No. | Pipe nipple opening diam. | Thickness | Packaging |
|--------------|---------------------------|-----------|-----------|
| KMS 185/12 | 1/2" – 12.5 cm | 4 mil | 1 unit |
| KMS 185/20 | 3/4" – 20 cm | 4 mil | 1 unit |
| KMS 10185/12 | 1/2" – 12.5 cm | 4 mil | 10 units |
| KMS 10185/20 | 3/4" – 20 cm | 4 mil | 10 units |

**8.1 Schluter®-KERDI-SEAL-MV**

Mixing valve seal with over-molded rubber gasket

| Item No. | Mixing valve opening diam. | Thickness | Packaging |
|-----------------|----------------------------|-----------|-----------|
| KMSMV 235/114 | 4-1/2" – 114 cm | 4 mil | 1 unit |
| KMSMV 10235/114 | 4-1/2" – 114 cm | 4 mil | 10 units |

**8.1 Schluter®-KERDI-KM**

Pipe seal

| Item No. | Dimensions | Thickness | Packaging |
|------------|----------------------|-----------|-----------|
| KM 5117/22 | 7" x 7" – 17 x 17 cm | 4 mil | 5 units |

Hole diameter, $\phi = 7/8" - 22 \text{ mm}$ **14.2 Schluter®-SHOWERPROFILE-WS**

Support profile

| Item No. | Height | Length |
|----------------|--------------|-------------------|
| SPWS 19 AE/100 | 5/16" - 8 mm | 39" - 1 m |
| SPWS 19 AE | 5/16" - 8 mm | 8' 2-1/2" - 2.5 m |

**14.2 Schluter®-SHOWERPROFILE-WSK**

Support profile - retrofit

| Item No. | Height | Length |
|-----------------|--------------|-------------------|
| SPWSK 52 AE/100 | 5/16" - 8 mm | 39" - 1 m |
| SPWSK 52 AE | 5/16" - 8 mm | 8' 2-1/2" - 2.5 m |

**14.2 Schluter®-SHOWERPROFILE-WSC**

Semi-circular lip insert

| Item No. | Height | Length |
|-----------------|--------------|-------------------|
| SPWSC 16 GS/100 | 5/16" - 8 mm | 39" - 1 m |
| SPWSC 16 GS | 5/16" - 8 mm | 8' 2-1/2" - 2.5 m |

**14.2 Schluter®-SHOWERPROFILE-WSL**

Straight lip insert

| Item No. | Height | Length |
|----------------|--------------|-------------------|
| SPWSL 30 T/100 | 5/16" - 8 mm | 39" - 1 m |
| SPWSL 30 T | 5/16" - 8 mm | 8' 2-1/2" - 2.5 m |

14.2 Schluter®-SHOWERPROFILE-WSK-EK

End cap

| Item No. | Height |
|----------------|--------------|
| EK/SPWSK 52 AE | 5/16" - 8 mm |



Schluter®-KERDI-TROWEL Trowel

| Item No. | Notch Size | Packaging |
|----------|------------------------|-----------|
| TRL-KER6 | 1/8" x 1/8" - 3 x 3 mm | 6 units |



8.3 Schluter®-KERDI-FIX Adhesive/sealant

| Item No. | Cartridge Volume |
|--------------------------|------------------|
| KERDIFIX / <i>color*</i> | 9.81 oz - 290 ml |

***Color Codes**









To complete the item number, add the *color* code (e.g., KERDIFIX / **BW**).

8.2 Schluter®-KERDI-DRAIN



4" Grate Options

| Tileable Covering Support | Anodized Aluminum | Stainless Steel |
|--|--|---|
|  <p>(ECS)</p> <p>Patent pending</p> |  <p>Brushed nickel (ATGB)</p>  <p>Brushed copper/bronze (AKGB)</p>  <p>Brushed brass (AMGB)</p> |  <p>Oil-rubbed bronze (EOB)</p>  <p>Stainless steel (E)</p> |

6" Grate Options

| Stainless Steel | Stainless Steel Cover for Cleanout Applications |
|--|---|
|  <p>(6E)</p>  <p>(6RE)</p> |  <p>(6CE)</p>  <p>(6RCE)</p> |



Flange Options

| ABS - 2" or 3" Outlet | PVC - 2" or 3" Outlet | Stainless Steel - 2" or 3" No-hub Outlet | Stainless Steel - 2" Threaded Outlet |
|---|---|--|---|
|  |  |  |  |

Listings and certifications can be referenced on page 19.



DRAIN KITS - ABS or PVC FLANGE - 2" OR 3" OUTLET

| Schluter®-KERDI-DRAIN - Components - ABS or PVC Flange | | | |
|---|------------------|---|------------------------|
| | Includes | Description | Quantity |
|  | 1 KERDI-DRAIN | Drain with integrated bonding flange and grate assembly | 1 |
| | 2 KERDI-KERECK-F | Preformed waterproofing corners | 4 inside and 2 outside |
|   | 3 KERDI-SEAL-PS | Pipe seal (3/4" - 20 mm) | 1 |
| | 4 KERDI-SEAL-MV | Mixing valve seal | 1 |

| 2" Drain Outlet | | |
|--|---------------------------|---------------------------|
| | ABS flange | PVC flange |
| 4" (100 mm) Square Grate | | |
| Tileable covering support (ECS)* | KD2/ABS/ECS ¹ | KD2/PVC/ECS ¹ |
| Stainless steel (E) | KD2/ABS/E ¹ | KD2/PVC/E ¹ |
| Oil-rubbed bronze stainless steel (EOB) | KD2/ABS/EOB | KD2/PVC/EOB |
| Brushed brass anod. alu. (AMGB) | KD2/ABS/AMGB ¹ | KD2/PVC/AMGB ¹ |
| Brushed copper/ bronze anod. alu. (AKGB) | KD2/ABS/AKGB ¹ | KD2/PVC/AKGB ¹ |
| Brushed nickel anod. alu. (ATGB) | KD2/ABS/ATGB ¹ | KD2/PVC/ATGB ¹ |
| 6" (150 mm) Square or Round Grate | | |
| Square grate stainless steel (6E) | KD2/ABS/6E ¹ | KD2/PVC/6E ¹ |
| Round grate stainless steel (6RE) | KD2/ABS/6RE ¹ | KD2/PVC/6RE ¹ |



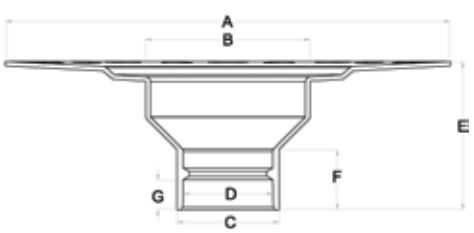

| 3" Drain Outlet | | |
|--|--------------------------|--------------------------|
| | ABS flange | PVC flange |
| 6" (150 mm) Square or Round Grate | | |
| Square grate stainless steel (6E) | KD3/ABS/6E ¹ | KD3/PVC/6E ¹ |
| Round grate stainless steel (6RE) | KD3/ABS/6RE ¹ | KD3/PVC/6RE ¹ |

¹ Listed by UPC®, CSA, ICC-ES PMG, and NSF
 * Patent pending

| Flange Measurements | | | |
|---|---|--------------------------------|--------------------------------|
| ABS or PVC | | | |
|  | | 2" (50 mm) drain outlet | 3" (75 mm) drain outlet |
| | A | 11-13/16" - 300 mm | 11-13/16" - 300 mm |
| | B | 4-17/32" - 115.2 mm | 4-17/32" - 115.2 mm |
| | C | 2-45/64" - 68.6 mm | 3-15/16" - 100 mm |
| | D | 2-3/8" - 60.5 mm | 3-1/2" - 88.8 mm |
| | E | 3-15/16" - 100 mm | 3-15/16" - 100 mm |
| | F | 1-39/64" - 40.6 mm | 2" - 50.8 mm |
| | G | 7/8" - 22.5 mm | 1-1/2" - 38.1 mm |



DRAIN KITS - STAINLESS STEEL FLANGE - 2" OR 3" NO-HUB OUTLET

| Schluter®-KERDI-DRAIN - Components - Stainless Steel Flange | | | |
|---|------------------|---|------------------------|
| Includes | Description | Quantity | |
|  | 1 KERDI-DRAIN | Drain with integrated bonding flange and grate assembly | 1 |
| | 2 KERDI-KERECK-F | Preformed waterproofing corners | 4 inside and 2 outside |
|    | 3 KERDI-SEAL-PS | Pipe seal (3/4" - 20 mm) | 1 |
| | 4 KERDI-SEAL-MV | Mixing valve seal | 1 |
| | 5 KERDI-FIX | Sealing and bonding compound (66 ml) | 1 |

| 2" No-hub Outlet | |
|--|-------------------------|
| | Stainless steel flange |
| 4" (100 mm) Square Grate | |
| Tileable covering support (ECS)* | KD2/E/ECS ¹ |
| Stainless steel (E) | KD2/E/E ¹ |
| Oil-rubbed bronze stainless steel (EOB) | KD2/E/EOB |
| Brushed brass anod. alu. (AMGB) | KD2/E/AMGB ¹ |
| Brushed copper/ bronze anod. alu. (AKGB) | KD2/E/AKGB ¹ |
| Brushed nickel anod. alu. (ATGB) | KD2/E/ATGB ¹ |
| 6" (150 mm) Square or Round Grate | |
| Square grate stainless steel (6E) | KD2/E/6E ¹ |
| Round grate stainless steel (6RE) | KD2/E/6RE ¹ |

| 3" No-hub Outlet | |
|--|------------------------|
| | Stainless steel flange |
| 6" (150 mm) Square or Round Grate | |
| Square grate stainless steel (6E) | KD3/E/6E ¹ |
| Round grate stainless steel (6RE) | KD3/E/6RE ¹ |

¹ Listed by UPC®, CSA, ICC-ES PMG, and NSF
 * Patent pending

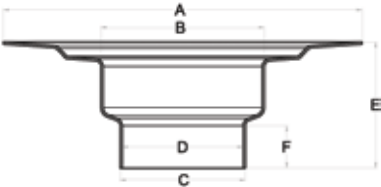
| Flange Measurements | | | |
|---|---|--------------------------|--------------------------|
| Stainless steel | | | |
| | | 2" (50 mm) no-hub outlet | 3" (75 mm) no-hub outlet |
|  | A | 9-27/32" - 250 mm | 9-27/32" - 250 mm |
| | B | 4-1/2" - 115.4 mm | 4-1/2" - 114 mm |
| | C | 2-13/32" - 61.3 mm | 3-7/16" - 87.4 mm |
| | D | 2-13/32" - 60.6 mm | 3-5/16" - 84.2 mm |
| | E | 3-11/32" - 85 mm | 3-7/16" - 87.4 mm |
| | F | 53/64" - 21 mm | 1-5/32" - 29.4 mm |

GRATE & FLANGE KITS (sold separately)

| Grate Kit - Components | | |
|---|---|---|
|  |  | Patent pending |
|  |  |  |
| Includes | Description | Quantity |
| 1a 1b Grate Assembly | a) For stainless steel and aluminum grates b) For tileable covering support | 1 |
| 2 KERDI-KERECK-F | Preformed waterproofing corners | 4 inside and 2 outside |
| 3 KERDI-SEAL-PS | Pipe seal (3/4" - 20 mm) | 1 |
| 4 KERDI-SEAL-MV | Mixing valve seal | 1 |

| Grate Kits | |
|--|-------------|
| Finish | Item No. |
| 4" (100 mm) Square Grate | |
| Tileable covering support (ECS)* | KD2/ECS/GR |
| Stainless steel (E) | KD2/E/GR |
| Oil-rubbed bronze stainless steel (EOB) | KD2/EOB/GR |
| Brushed brass anod. alu. (AMGB) | KD2/AMGB/GR |
| Brushed copper/ bronze anod. alu. (AKGB) | KD2/AKGB/GR |
| Brushed nickel anod. alu. (ATGB) | KD2/ATGB/GR |
| Stainless steel (E) with stainless steel height adjustment collar and lateral adjustment ring | KD2/E/E/GR |
| 6" (150 mm) Square or Round Grate | |
| Square grate stainless steel (6E) | KD2/6E/GR |
| Round grate stainless steel (6RE) | KD2/6RE/GR |
| 6" (150 mm) Square or Round Cover | |
| Square cover stainless steel (6CE) | KD-GR6C-E |
| Round cover stainless steel (6RCE) | KD-GR6RC-E |

Note: 6" square and round covers do not include the seals and corners.

| Flange Kit - Components | |
|---|----------|
|  | |
| Includes | Quantity |
| Drain with integrated bonding flange | 1 |

| Flange Kits | | |
|--------------------------------------|------------|-----------|
| Material | Item No. | \$ / Unit |
| 2" (50 mm) Drain Outlet | | |
| ABS | KD2/ABS/FL | 26.45 |
| PVC | KD2/PVC/FL | 26.45 |
| Stainless Steel with no-hub outlet | KD2/E/FL | 169.60 |
| Stainless Steel with threaded outlet | KD2/ETH/FL | 182.50 |
| 3" (75 mm) Drain Outlet | | |
| ABS | KD3/ABS/FL | 35.69 |
| PVC | KD3/PVC/FL | 35.69 |
| Stainless Steel with no-hub outlet | KD3/E/FL | 169.60 |



Please note that flanges with 3" outlets are intended for use with 6" grates as these combinations have listings and certifications while flanges with 3" outlet combined with 4" grates do not. Please refer to the Product Listings and Certifications Table on page 19.



DRAIN ADAPTOR KIT FOR USE WITH RESIDENTIAL CLAMPING RING DRAINS - ABS

| Schluter®-KERDI-DRAIN with residential adaptor ring and ABS flange | | | |
|--|------------------|---|------------------------|
| | Includes | Description | Quantity |
| | 1 KERDI-DRAIN | Drain with integrated bonding flange and grate assembly | 1 |
| | 2 Adaptor ring* | For residential clamping ring drains | 1 |
| | 3 KERDI-KERECK-F | Preformed waterproofing corners | 4 inside and 2 outside |
| | 4 KERDI-SEAL-PS | Pipe seal (3/4" - 20 mm) | 1 |
| | 5 KERDI-SEAL-MV | Mixing valve seal | 1 |
| | 6 KERDI-FIX | Sealing and bonding compound (66 ml) | 1 |

* © Schluter-Systems L.P., U.S. patent No. D593,641, other patents pending

| Residential Adaptor Kits - ABS Flange | |
|--|--------------------|
| | ABS bonding flange |
| 4" (100 mm) Square Grate | |
| Stainless steel (E) | KDAR/ABS/E |
| Oil-rubbed bronze stainless steel (EOB) | KDAR/ABS/EOB |
| Brushed brass anod. alu. (AMGB) | KDAR/ABS/AMGB |
| Brushed copper/ bronze anod. alu. (AKGB) | KDAR/ABS/AKGB |
| Brushed nickel anod. alu. (ATGB) | KDAR/ABS/ATGB |

| Flange and adaptor ring measurements - Residential | | |
|--|---|--------------------|
| ABS | | |
| | A | 11-13/16" - 300 mm |
| | B | 2-13/32" - 60.7 mm |
| | C | 2.73" - 69.3 mm |
| | D | 5-1/4" - 133.4 mm |
| | E | 2-29/32" - 74 mm |
| | F | 1-1/64" - 25.9 mm |
| | G | 2-1/16" - 52.6 mm |



DRAIN ADAPTOR KIT FOR USE WITH COMMERCIAL CLAMPING RING DRAINS - ABS

| Schluter®-KERDI-DRAIN with commercial adaptor ring and ABS flange | | | |
|---|-----------------|---|----------|
| | Includes | Description | Quantity |
|  | 1 KERDI-DRAIN | Drain with integrated bonding flange and grate assembly | 1 |
| | 2 Adaptor ring* | For commercial clamping ring drains | |
| | 3 KERDI-FIX | Sealing and bonding compound (66 ml) | |

* © Schluter-Systems L.P., U.S. patent No. D593,641, other patents pending

| Commercial Adaptor Kits - ABS Flange | | |
|--|-----------------------------|-----------------------------|
| | Standard ABS bonding flange | Extended ABS bonding flange |
| 4" (100 mm) Square Grate | | |
| Tileable covering support (ECS)* | KDA/ABS/ECS | KDA/ABSL/ECS |
| Stainless steel (E) | KDA/ABS/E | KDA/ABSL/E |
| Oil-rubbed bronze stainless steel (EOB) | KDA/ABS/EOB | KDA/ABSL/EOB |
| Brushed brass anod. alu. (AMGB) | KDA/ABS/AMGB | KDA/ABSL/AMGB |
| Brushed copper/ bronze anod. alu. (AKGB) | KDA/ABS/AKGB | KDA/ABSL/AKGB |
| Brushed nickel anod. alu. (ATGB) | KDA/ABS/ATGB | KDA/ABSL/ATGB |
| 6" (150 mm) Square or Round Grate | | |
| Square grate stainless steel (6E) | KDA/ABS/6E | KDA/ABSL/6E |
| Round grate stainless steel (6RE) | KDA/ABS/6RE | KDA/ABSL/6RE |

* Patent pending

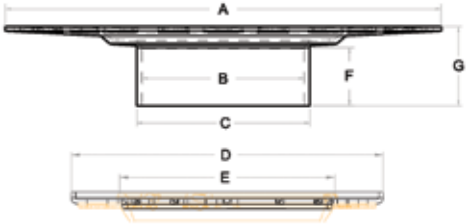
| Flange and adaptor ring measurements - Commercial | | | |
|---|---|---------------------|---------------------|
| ABS | | | |
|  | | Standard | Extended |
| | A | 11-13/16" - 300 mm | 11-13/16" - 300 mm |
| | B | 4-13/32" - 111.8 mm | 4-13/32" - 111.8 mm |
| | C | 4-11/16" - 118.9 mm | 4-11/16" - 118.9 mm |
| | D | 7-1/2" - 191 mm | 7-1/2" - 191 mm |
| | E | 5-7/64" - 130 mm | 5-7/64" - 130 mm |
| | F | 1-9/16" - 39.7 mm | 3-1/16" - 77.8 mm |
| | G | 2-9/64" - 54.3 mm | 3-41/64" - 92.4 mm |



DRAIN ADAPTOR KIT FOR USE WITH COMMERCIAL CLAMPING RING DRAINS - STAINLESS STEEL

| Schluter®-KERDI-DRAIN with commercial adaptor ring and stainless steel flange | | | |
|---|-----------------|---|----------|
| Image | Includes | Description | Quantity |
| | 1 KERDI-DRAIN | Drain with integrated bonding flange and grate assembly | 1 |
| | 2 Adaptor ring* | For commercial clamping ring drains | |
| | 3 KERDI-FIX | Sealing and bonding compound (66 ml) | |

* © Schluter-Systems L.P., U.S. patent No. D593,641, other patents pending

| Commercial Adaptor Kits - Stainless Steel Flange | |
|--|--------------------------------|
| | Stainless steel bonding flange |
| 4" (100 mm) Square Grate | |
| Tileable covering support (ECS)* | KDA/E/ECS |
| Stainless steel (E) | KDA/E/E |
| Oil-rubbed bronze stainless steel (EOB) | KDA/E/EOB |
| Brushed brass anod. alu. (AMGB) | KDA/E/AMGB |
| Brushed copper/ bronze anod. alu. (AKGB) | KDA/E/AKGB |
| Brushed nickel anod. alu. (ATGB) | KDA/E/ATGB |
| 6" (150 mm) Square or Round Grate | |
| Square grate stainless steel (6E) | KDA/E/6E |
| Round grate stainless steel (6RE) | KDA/E/6RE |

* Patent pending

| Flange and adaptor ring measurements - Commercial | | |
|---|---|---------------------|
| Stainless steel | | |
| | A | 9-27/32" - 250 mm |
| | B | 4-9/16" - 115.7 mm |
| | C | 4-11/16" - 118.7 mm |
| | D | 7-1/2" - 191 mm |
| | E | 5-7/64" - 130 mm |
| | F | 1-9/16" - 39.7 mm |
| | G | 2-3/16" - 56.5 mm |

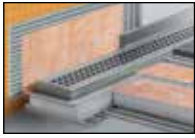

Note: There are multiple selections to be made for this product. Start by selecting the appropriate flange length then proceed to grate selection accordingly, keeping in mind there are two frame heights with two grate options (A or B), and a frameless option (D).

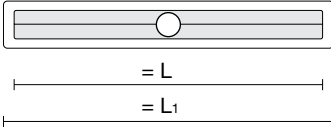

8.7 Schluter®-KERDI-LINE Bonding flange - stainless steel - center outlet

| L = in. - cm | L ₁ = in. - cm | Item No. |
|-----------------|------------------------------|--------------|
| 20 - 50 | 22 - 55 | KLV 60 E 50 |
| 24 - 60 | 26 - 65 | KLV 60 E 60 |
| 28 - 70 | 30 - 75 | KLV 60 E 70 |
| 32 - 80 | 34 - 85 | KLV 60 E 80 |
| 36 - 90 | 38 - 95 | KLV 60 E 90 |
| 40 - 100 | 42 - 105 | KLV 60 E 100 |
| 44 - 110 | 46 - 115 | KLV 60 E 110 |
| 48 - 120 | 50 - 125 | KLV 60 E 120 |
| 52 - 130 | 54 - 135 | KLV 60 E 130 |
| 56 - 140 | 58 - 145 | KLV 60 E 140 |
| 60 - 150 | 62 - 155 | KLV 60 E 150 |
| 64 - 160 | 66 - 165 | KLV 60 E 160 |
| 68 - 170 | 70 - 175 | KLV 60 E 170 |
| 72 - 180 | 74 - 185 | KLV 60 E 180 |

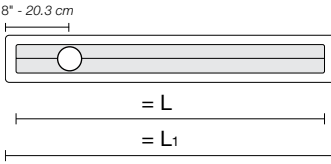

8.7 Schluter®-KERDI-LINE Bonding flange - stainless steel - off-set outlet

| L = in. - cm | L ₁ = in. - cm | Item No. |
|-----------------|------------------------------|---------------|
| 28 - 70 | 30 - 75 | KLVO 60 E 70 |
| 32 - 80 | 34 - 85 | KLVO 60 E 80 |
| 36 - 90 | 38 - 95 | KLVO 60 E 90 |
| 40 - 100 | 42 - 105 | KLVO 60 E 100 |
| 44 - 110 | 46 - 115 | KLVO 60 E 110 |
| 48 - 120 | 50 - 125 | KLVO 60 E 120 |

Note : Please see page 19 for listings and certifications.

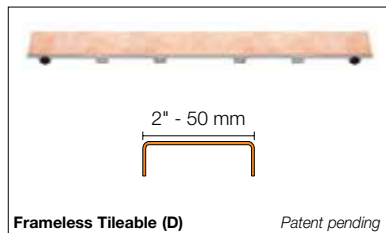
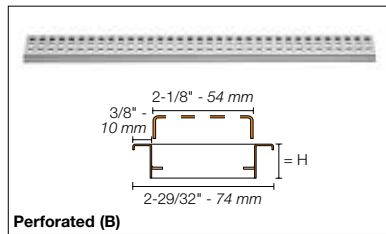
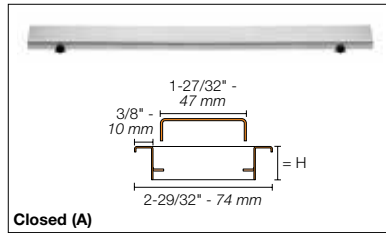

8.7 Schluter®-KERDI-LINE Grate assemblies

| Length = in. - cm | Item No. | | Item No. | |
|----------------------|------------|----------------|---|--|
| | Closed (A) | Perforated (B) | Frameless Tileable (D) - Patent pending | |

| | | | Center outlet | Off-set outlet |
|--|--|--|---------------|----------------|
|--|--|--|---------------|----------------|

3/4" - 19 mm frame height for 1/8" to 9/16" - 3 mm to 15 mm -thick coverings

| | | | | |
|----------|----------------|---------------|-----------|-------------|
| 20 - 50 | KLAR 19 EB 50 | KLB 19 EB 50 | KLDRE 50 | - |
| 24 - 60 | KLAR 19 EB 60 | KLB 19 EB 60 | KLDRE 60 | - |
| 28 - 70 | KLAR 19 EB 70 | KLB 19 EB 70 | KLDRE 70 | KLDRO E 70 |
| 32 - 80 | KLAR 19 EB 80 | KLB 19 EB 80 | KLDRE 80 | KLDRO E 80 |
| 36 - 90 | KLAR 19 EB 90 | KLB 19 EB 90 | KLDRE 90 | KLDRO E 90 |
| 40 - 100 | KLAR 19 EB 100 | KLB 19 EB 100 | KLDRE 100 | KLDRO E 100 |
| 44 - 110 | KLAR 19 EB 110 | KLB 19 EB 110 | KLDRE 110 | KLDRO E 110 |
| 48 - 120 | KLAR 19 EB 120 | KLB 19 EB 120 | KLDRE 120 | KLDRO E 120 |
| 52 - 130 | KLAR 19 EB 130 | KLB 19 EB 130 | KLDRE 130 | - |
| 56 - 140 | KLAR 19 EB 140 | KLB 19 EB 140 | KLDRE 140 | - |
| 60 - 150 | KLAR 19 EB 150 | KLB 19 EB 150 | KLDRE 150 | - |
| 64 - 160 | KLAR 19 EB 160 | KLB 19 EB 160 | KLDRE 160 | - |
| 68 - 170 | KLAR 19 EB 170 | KLB 19 EB 170 | KLDRE 170 | - |
| 72 - 180 | KLAR 19 EB 180 | KLB 19 EB 180 | KLDRE 180 | - |

1-1/8" - 30 mm frame height for 1/2" to 1" - 13 mm to 25 mm -thick coverings

| | | | | |
|----------|----------------|---------------|--|--|
| 20 - 50 | KLAR 30 EB 50 | KLB 30 EB 50 | | |
| 24 - 60 | KLAR 30 EB 60 | KLB 30 EB 60 | | |
| 28 - 70 | KLAR 30 EB 70 | KLB 30 EB 70 | | |
| 32 - 80 | KLAR 30 EB 80 | KLB 30 EB 80 | | |
| 36 - 90 | KLAR 30 EB 90 | KLB 30 EB 90 | | |
| 40 - 100 | KLAR 30 EB 100 | KLB 30 EB 100 | | |
| 44 - 110 | KLAR 30 EB 110 | KLB 30 EB 110 | | |
| 48 - 120 | KLAR 30 EB 120 | KLB 30 EB 120 | | |

Note: The perforated grate (B) is also available with a locking mechanism to prevent removal of the grate, for more information contact customer service at 1-800-472-4588 (US) or 1-800-667-8746 (CANADA).



14.1 Schluter®-SHOWERPROFILE-SA Two-part tapered edging profile

| Item No. | H = in. - mm | H ₁ = in. - mm | H ₂ = in. - mm |
|---------------------|--------------|---------------------------|---------------------------|
| L = 47-1/4" - 1.2 m | | | |
| SPSA 50 EB/120 | 3/16 - 5 | 1/4 - 6 | 1-3/16 - 30 |
| L = 63" - 1.6 m | | | |
| SPSA 50 EB/160 | 3/16 - 5 | 1/4 - 6 | 1-1/2 - 38 |
| L = 78-3/4" - 2 m | | | |
| SPSA 50 EB/200 | 3/16 - 5 | 1/4 - 6 | 1-13/16 - 46 |

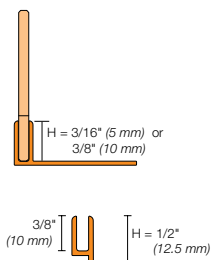

14.1 Schluter®-SHOWERPROFILE-SB Two-part tapered edging profile

| Item No. | H = in. - mm | H ₁ = in. - mm | H ₂ = in. - mm |
|---------------------|--------------|---------------------------|---------------------------|
| L = 47-1/4" - 1.2 m | | | |
| SPSB 100 EB/120 | 3/8 - 10 | 3/8 - 10 | 1-11/32 - 34 |
| SPSB 125 EB/120 | 1/2 - 12.5 | 3/8 - 10 | 1-11/32 - 34 |
| L = 63" - 1.6 m | | | |
| SPSB 100 EB/160 | 3/8 - 10 | 3/8 - 10 | 1-21/32 - 42 |
| SPSB 125 EB/160 | 1/2 - 12.5 | 3/8 - 10 | 1-21/32 - 42 |
| L = 78-3/4" - 2 m | | | |
| SPSB 100 EB/200 | 3/8 - 10 | 3/8 - 10 | 2 - 50 |
| SPSB 125 EB/200 | 1/2 - 12.5 | 3/8 - 10 | 2 - 50 |

Note: Other sizes available. Contact Customer Service for price and availability.

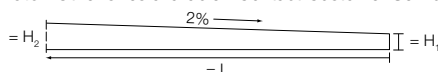



14.1 Schluter®-SHOWERPROFILE-R

Two-part wall transition profile

| Item No. | Height |
|-----------------|---------------------------------|
| L = 39" - 1 m | |
| SPRA 23 EB/100 | 29/32" - 1-3/8" (23 - 35 mm) |
| SPRA 33 EB/100 | 1-5/16" - 1-25/32" (33 - 45 mm) |
| L = 55" - 1.4 m | |
| SPRA 23 EB/140 | 29/32" - 1-3/8" (23 - 35 mm) |
| SPRA 33 EB/140 | 1-5/16" - 1-25/32" (33 - 45 mm) |

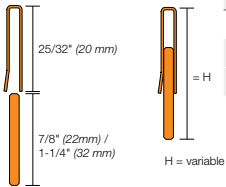

Note: When the SHOWERPROFILE-S/-R is not used with the Schluter®-Shower System the profile is covered under the Schluter®-Systems Wall and Countertop Profiles 5-Year Limited Warranty.



14.1 Schluter®-KERDI-LINE-FC

Cover plate

| Item No. | Width |
|-------------|----------------|
| V / KLEB 35 | 1-3/8" - 35 mm |

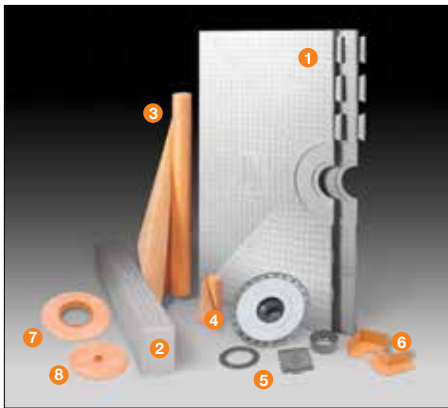
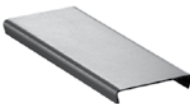
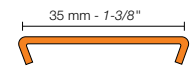

Schluter®-KERDI-SHOWER-KIT

| Includes | Description | Quantity | | |
|-------------------|--|------------------------|-----------|-----------|
| | | 48" x 48" | 72" x 72" | 32" x 60" |
| 1 KERDI-SHOWER-ST | Shower Tray | 1 | 1 | 1 |
| 2 KERDI-SHOWER-SC | Shower Curb 48" x 6" x 4-1/2" | 1 | 2 | 2 |
| 3 KERDI 10 M | Waterproofing membrane 3' 3" x 33' | | | 1 |
| KERDI 12 M | Waterproofing membrane 3' 3" x 39' 4" | 1 | | |
| KERDI 20 M | Waterproofing membrane 3' 3" x 65' 7" | | 1 | |
| 4 KERDI-BAND | Waterproofing strip 5" x 33' | 1 | 2 | 1 |
| 5 KERDI-DRAIN | Drain, with integrated bonding flange with 2" (50 mm) outlet | 1 | 1 | 1 |
| 6 KERDI-KERECK-F | Preformed waterproofing corners | 4 inside and 2 outside | | |
| 7 KERDI-SEAL-PS | Pipe seal (3/4" - 20 mm) | 1 | | |
| 8 KERDI-SEAL-MV | Mixing valve seal | 1 | | |

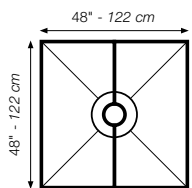

| 48" x 48" (122 x 122 cm) Kit | | |
|------------------------------|----------------|------------------------------------|
| Item No. | Drain Material | Grate finish |
| KK122ABSECS | ABS | Tileable covering support |
| KK122ABSE | ABS | Stainless steel 304 (1.4301 = V2A) |
| KK122ABSEOB | ABS | Oil-rubbed bronze stainless steel |
| KK122ABSATGB | ABS | Brushed nickel anodized aluminum |
| KK122ABSAKGB | ABS | Brushed copper/bronze anod. alu. |
| KK122ABSAMGB | ABS | Brushed brass anodized aluminum |
| KK122PVCECS | PVC | Tileable covering support |
| KK122PVCE | PVC | Stainless steel 304 (1.4301 = V2A) |
| KK122PVCEOB | PVC | Oil-rubbed bronze stainless steel |
| KK122PVCATGB | PVC | Brushed nickel anodized aluminum |
| KK122PVCAGKB | PVC | Brushed copper/bronze anod. alu. |
| KK122PVCAMGB | PVC | Brushed brass anodized aluminum |

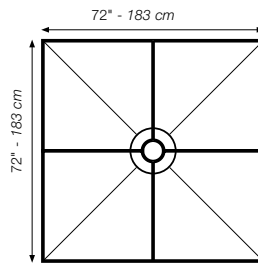

| 72" x 72" (183 x 183 cm) Kit | | |
|------------------------------|----------------|------------------------------------|
| Item No. | Drain Material | Grate finish |
| KK183ABSECS | ABS | Tileable covering support |
| KK183ABSE | ABS | Stainless steel 304 (1.4301 = V2A) |
| KK183ABSEOB | ABS | Oil-rubbed bronze stainless steel |
| KK183ABSATGB | ABS | Brushed nickel anodized aluminum |
| KK183ABSAKGB | ABS | Brushed copper/bronze anod. alu. |
| KK183ABSAMGB | ABS | Brushed brass anodized aluminum |
| KK183PVCECS | PVC | Tileable covering support |
| KK183PVCE | PVC | Stainless steel 304 (1.4301 = V2A) |
| KK183PVCEOB | PVC | Oil-rubbed bronze stainless steel |
| KK183PVCATGB | PVC | Brushed nickel anodized aluminum |
| KK183PVCAGKB | PVC | Brushed copper/bronze anod. alu. |
| KK183PVCAMGB | PVC | Brushed brass anodized aluminum |

SHOWER SYSTEM

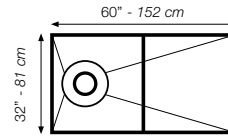
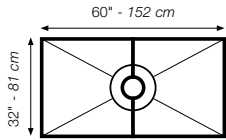

Note: Tray features off-center drain placement: 10" (25.4 cm) o.c. from end of tray.

| 32" x 60" (81 x 152 cm) Kit | | |
|-----------------------------|----------------|------------------------------------|
| Item No. | Drain Material | Grate finish |
| KK81152ABSECS | ABS | Tileable covering support |
| KK81152ABSE | ABS | Stainless steel 304 (1.4301 = V2A) |
| KK81152ABSEOB | ABS | Oil-rubbed bronze stainless steel |
| KK81152ABSATGB | ABS | Brushed nickel anodized aluminum |
| KK81152ABSAKGB | ABS | Brushed copper/bronze anod. alu. |
| KK81152ABSAMGB | ABS | Brushed brass anodized aluminum |
| KK81152PVCECS | PVC | Tileable covering support |
| KK81152PVCE | PVC | Stainless steel 304 (1.4301 = V2A) |
| KK81152PVCEOB | PVC | Oil-rubbed bronze stainless steel |
| KK81152PVCATGB | PVC | Brushed nickel anodized aluminum |
| KK81152PVCAGB | PVC | Brushed copper/bronze anod. alu. |
| KK81152PVCAMGB | PVC | Brushed brass anodized aluminum |

| 32" x 60" (81 x 152 cm) Kit with off-center drain placement | | |
|---|----------------|------------------------------------|
| Item No. | Drain Material | Grate finish |
| KKB81152ABSECS | ABS | Tileable covering support |
| KKB81152ABSE | ABS | Stainless steel 304 (1.4301 = V2A) |
| KKB81152ABSEOB | ABS | Oil-rubbed bronze stainless steel |
| KKB81152ABSATGB | ABS | Brushed nickel anodized aluminum |
| KKB81152ABSAKGB | ABS | Brushed copper/bronze anod. alu. |
| KKB81152ABSAMGB | ABS | Brushed brass anodized aluminum |
| KKB81152PVCECS | PVC | Tileable covering support |
| KKB81152PVCE | PVC | Stainless steel 304 (1.4301 = V2A) |
| KKB81152PVCEOB | PVC | Oil-rubbed bronze stainless steel |
| KKB81152PVCATGB | PVC | Brushed nickel anodized aluminum |
| KKB81152PVCAGB | PVC | Brushed copper/bronze anod. alu. |
| KKB81152PVCAMGB | PVC | Brushed brass anodized aluminum |

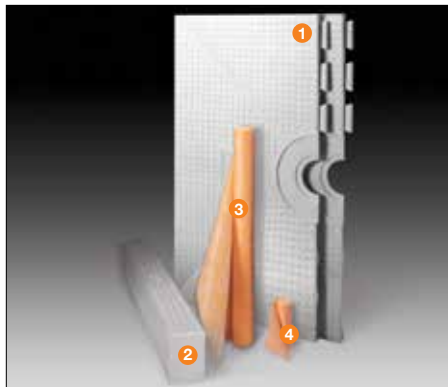

| Schluter®-KERDI-SHOWER-KIT WITHOUT THE DRAIN | | | | | |
|--|-----------------|---------------------------------------|-----------|-----------|---|
| Includes | Description | Quantity | | | |
| | | 48" x 48" | 72" x 72" | 32" x 60" | |
| 1 | KERDI-SHOWER-ST | Shower tray | 1 | 1 | 1 |
| 2 | KERDI-SHOWER-SC | Shower curb 48" x 6" x 4-1/2" | 1 | 2 | 2 |
| 3 | KERDI 10 M | Waterproofing membrane 3' 3" x 33' | | | 1 |
| | KERDI 12 M | Waterproofing membrane 3' 3" x 39' 4" | 1 | | |
| | KERDI 20 M | Waterproofing membrane 3' 3" x 65' 7" | | 1 | |
| 4 | KERDI-BAND | Waterproofing strip 5" x 33' | 1 | 2 | 1 |

| Item No. | Tray size |
|----------|----------------------------|
| KK122 | 48" x 48" |
| KK183 | 72" x 72" |
| KK81152 | 32" x 60" |
| KKB81152 | 32" x 60" off-center drain |

Product Listings and Certifications Table

| Schluter®-KERDI-DRAIN | | | | | | | | | | |
|---|---------------------|-----|------|------|------|------|---------------------|-----|-----|------|
| Bonding Flange 2" (50 mm) Outlet | Grate - 4" (100 mm) | | | | | | Grate - 6" (150 mm) | | | |
| | E | EOB | AMGB | AKGB | ATGB | ECS* | 6E | 6RE | 6CE | 6RCE |
| ABS / PVC | 1 | - | 1 | 1 | 1 | 1 | 1 | 1 | 2 | 2 |
| Stainless steel | 1 | - | 1 | 1 | 1 | 1 | 1 | 1 | 2 | 2 |
| Bonding Flange 3" (75 mm) Outlet | Grate - 6" (150 mm) | | | | | | | | | |
| | 6E | | 6RE | | 6CE | | 6RCE | | | |
| ABS / PVC | 1 | | 1 | | 2 | | 2 | | | |
| Stainless steel | 1 | | 1 | | 2 | | 2 | | | |
| Schluter®-KERDI-LINE | | | | | | | | | | |
| Bonding Flange | Grate | | | | | | | | | |
| | A | | | B | | | D* | | | |
| Center outlet - 20" - 48" (50 cm - 120 cm) | 1 | | | 1 | | | 1 | | | |
| Center outlet - 52" - 72" (130 cm - 180 cm) | 1 | | | 1 | | | 1 | | | |
| Off-set outlet - 28" - 48" (70 cm - 120 cm) | 1 | | | 1 | | | 1 | | | |

Various configurations of KERDI-DRAIN and KERDI-LINE are listed by UPC®, CSA, ICC-ES PMG, and NSF as shown in the table above.

1 - Listed by UPC®, CSA, NSF, and ICC-ES PMG

2 - Listed by CSA

* Patent pending

For copies of these documents, please contact Schluter®-Systems at 800-472-4588 (USA) or 800-667-8746 (Canada) or by email at info@schluter.com. Links to the documents can also be accessed at www.schluter.com.



Schluter®-Shower System 10-Year Limited Warranty

COVERAGE AND CONDITIONS: Subject to the conditions and limitations as stated hereinafter, **Schluter-Systems*** warrants that the **Schluter®-Shower System** (the "Products")** will meet all composition and performance criteria for a period of ten (10) years from the date of purchase only when the Products are used and installed in accordance with the terms and conditions of the Schluter®-Shower System Installation Handbook and industry standard guidelines that are not in conflict with the Handbook in effect at the time of installation. Further, efflorescence is considered to be a natural occurrence with cementitious materials and is therefore not considered to be a defective condition and is not covered by this warranty. It is the responsibility of the owner/builder/installer to ensure the suitability of all building materials and all associated building materials for the owner's intended use. It is recommended that the owner consult with an experienced and professional installer.

RESOLUTION: If the Products fail to meet this warranty, then the owner's exclusive remedy and the sole obligation of Schluter-Systems, at its election, shall be to a) reinstall or replace the failed portion of the tile assembly or b) pay an amount not to exceed the original square foot cost of the installation of the tile assembly verified to be defective. Tile assembly is defined to include all Schluter®-KERDI products, non-reusable tile surfaces, and the appropriate setting and grouting materials. Further, due to conditions beyond the control of Schluter-Systems (e.g., color and shade availability, discontinuation, normal wear and tear), Schluter-Systems cannot guarantee or warrant an exact match to the specific tile, stone, or other covering materials used in the installation. In such events, substantially similar materials may be substituted.

DISCLAIMER: THERE ARE NO WARRANTIES BEYOND THIS EXPRESSED WARRANTY AS STATED ABOVE. ALL OTHER WARRANTIES, REPRESENTATIONS OR CONDITIONS, EXPRESSED OR IMPLIED, ARE DISCLAIMED AND EXCLUDED, INCLUDING WARRANTIES, REPRESENTATIONS OR CONDITIONS OF **MERCHANTABILITY** OR FITNESS FOR A PARTICULAR PURPOSE ARISING BY STATUTE OR OTHERWISE BY LAW OR FROM A COURSE OF DEALING OR USAGE OF TRADE. SCHLUTER-SYSTEMS EXCLUDES AND IN NO EVENT SHALL HAVE ANY LIABILITY FOR LOST PROFITS OR ANY OTHER INDIRECT, SPECIAL, INCIDENTAL, PUNITIVE, EXEMPLARY, OR CONSEQUENTIAL DAMAGES, ARISING OUT OF OR OTHERWISE CONNECTED TO FAILURE OF THE PRODUCTS, NOR MISUSE OF THE PRODUCTS OR FAILURE TO PROPERLY MAINTAIN THE SHOWER OR BATHTUB SURROUND. REGARDLESS OF ANY STRICT LIABILITY, ACTIVE OR PASSIVE NEGLIGENCE OF SCHLUTER-SYSTEMS, AND REGARDLESS OF THE LEGAL THEORY (CONTRACT OR TORT OR EXTRA-CONTRACTUAL OR OTHER), NOR FROM ACTS OF WAR, TERRORISM, FAULTY AND NEGLIGENT PENETRATION OF THE SYSTEM, FIRES, EXPLOSIONS, ACTS OF GOD, INTENTIONAL ACTS OF DESTRUCTION OR ANY LOSSES DUE TO STRUCTURAL FAILURE OR OTHER CAUSES UNRELATED TO THE PRODUCTS OR DELAYS, OR ANY OTHER INCIDENTAL OR CONSEQUENTIAL DAMAGES. THIS WARRANTY IS GIVEN IN LIEU OF ANY OTHER WARRANTY EXPRESSED OR IMPLIED. THE REMEDIES CONTAINED HEREIN ARE THE ONLY REMEDIES AVAILABLE FOR BREACH OF THIS WARRANTY. THIS LIMITED WARRANTY GIVES YOU SPECIFIC LEGAL RIGHTS; SOME STATES AND PROVINCES DO NOT ALLOW DISCLAIMERS OR OTHER RESTRICTIONS OF IMPLIED WARRANTIES, SO SOME OF THE ABOVE DISCLAIMERS MAY NOT APPLY TO YOU.

TRANSFERABILITY: This Limited Warranty extends ONLY to the original end user (defined as original intended owner and user of the property/unit in which the installation is incorporated - herein referred to as "Owner") and is not transferable or assignable, unless approved in writing by the Technical Director or an Officer of Schluter-Systems or otherwise prohibited by specific state or provincial law.

MODIFICATIONS TO WARRANTY: No changes or modification of any terms or conditions of this warranty are allowed unless authorized by written agreement and signed by the Technical Director or an Officer of Schluter-Systems.

EFFECTIVE DATE: This warranty shall supersede and replace any and all prior oral or written warranties, agreements, or other such representations made by or on behalf of Schluter-Systems relative to the Products or the application of the Products and shall apply to any installation occurring on or after January 1, 2013.

CLAIMS ON THIS LIMITED WARRANTY: To make a claim under this Limited Warranty, the Owner must provide Schluter-Systems with written notice within 30 days of any alleged defect in the Products covered by this Limited Warranty, together with date and proof of purchase of the Products, proof of the costs of the original installation and name and address of all installers, failing which this Limited Warranty shall be of no legal effect. Schluter-Systems reserves the right at its election and as a condition of this Limited Warranty to inspect the alleged failed and defective condition.

All U.S. Claims shall be sent to:

Schluter Systems L.P.
Attn: Warranty Claims Dept.
194 Pleasant Ridge Road
Plattsburgh, NY 12901-5841

All Canadian Claims shall be sent to:

Schluter Systems (Canada), Inc.
Attn: Warranty Claims Dept.
21100 chemin Ste-Marie
Ste-Anne-de-Bellevue, QC H9X 3Y8

*For the purpose of this warranty **Schluter Systems, L.P.** shall provide the warranty for all products for end users located in the United States, and **Schluter Systems (Canada) Inc.** shall provide the warranty for all products for end users located in Canada. This warranty is limited to sales of the Products made in and intended for use in the United States and Canada.

****Schluter®-Shower System (the "Products"):** The Products are defined to include all Schluter®-KERDI products referred to in the Handbook and used in the integrated Schluter®-Shower System.



Schluter Systems L.P. • 194 Pleasant Ridge Road, Plattsburgh, NY 12901-5841 • Tel.: 800-472-4588 • Fax: 800-477-9783
Schluter Systems (Canada) Inc. • 21100 chemin Ste-Marie, Ste-Anne-de-Bellevue, QC H9X 3Y8 • Tel.: 800-667-8746 • Fax: 877-667-2410
info@schluter.com

www.schluter.com